

Installation Instructions

VEHICLE APPLICATION

Year: 2012 - 2016
Make: Jeep
Model: Wrangler JK
Engine: 3.6L

TOOLS REQUIRED

- 10mm Wrench & Socket
- 5/16" Nut Driver & 1/4" Nut Driver or Flat Blade Screwdriver
- Phillips Screwdriver, Pliers or Channel locks

S&B FILTER MAINTENANCE

Cleanable (KF-1057). If the enclosed filter is Red, it came pre-oiled from the factory. Please visit www.sbfilters.com for exact oil amount required after cleaning.

Disposable (KF-1057D). If the enclosed filter is White, it is a disposable filter and should be discarded once it reaches capacity. This filter (does not require oil). For more info on S&B's disposable filter, visit www.sbfilters.com.

NOTES

Kit may not fit with the following

Aftermarket Parts installed:

- Body Lift or Lowering Kit
- Custom Hood
- Throttle Body Spacer/ Upgrade

CARB Status - EXEMPT

CARB EO #: D-590-11

Legal for use in CA or other states adopting
CA emissions standards
See [Page 4](#) for more info.

BEFORE YOU START

- Please read the entire product guide before proceeding.
- Ensure all components listed on page 4 are present.
- If you are missing any of the components, call our customer support at (909) 947-0015.
- Do not work on your vehicle while engine is hot.
- Make sure the engine is turned off and the vehicle is in Park or the Parking Brake is set.

1. With the ignition switched off and the parking brake set, disconnect the negative battery cable on the battery. **Note: Failure to disconnect the battery may cause the CEL to illuminate upon completion of the installation and subsequent operation. Do not skip this step!**



2. Lift and remove the plastic engine cover.

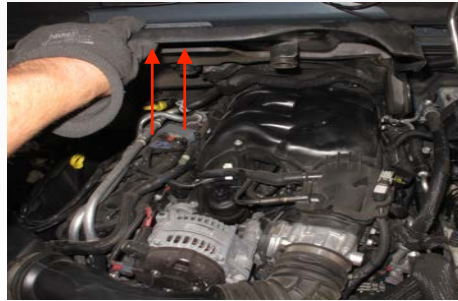

3. Loosen the hose clamp at the throttle body and pull the tube out.



4. Remove the two retaining bolts on the stock intake tube. **Note: You will need to reuse the retaining bolts to secure the radiator hose on [Step 24](#).**



5. Loosen the hose clamp at the stock air box and pull the tube out.



6. Once everything is loosened, pull the intake tube out exposing the IAT sensor.



7. Lift the tab on the IAT sensor and use pliers if necessary to turn it counter clockwise and remove it from the tube. Be careful not to break the sensor. Remove the sensor from its harness. Pull the intake tube out completely.



SEE EXPLODED VIEW ON PAGE 5



Installation Instructions (continued)

8. Pull the stock CCV hose from the air box and the breather line. For the breather line, use a flat blade screwdriver if necessary to pry the hose off the line. Be careful not to damage the breather line. Remove the hose completely.



9. Once the sensor and breather are out, remove the stock air box completely by pulling up. Be careful not to break the factory box tabs.



10. Install the Tube Seal (N) by pushing the seal into the Air Box (H).



11. Install the Air Tube (O) into the Air Box (H) by pushing the tube through the Tube Seal (N).



12. Slip the Air Filter (F) over the Air Tube (O) and tighten down the #80 Hose Clamp (G).



13. Install the Hump Coupler (Q) to the Air Tube (O) and tighten down the #52 Hose Clamp (P) on the tube end. Leave the other clamp on the coupler that goes into the throttle body loose.



14. Install the Bracket (I) to the side of the Air Box (H) with the supplied Screw (K) and Washer (J). Apply Loctite Thread Locker (U) to the threads on the Screw (K) before installing the bracket. Insert the Grommet (L) in between the hole on the bottom end of the bracket.



15. Install the Grommet (L) to the bottom of the Air Tube (O).



16. Reinstall the IAT sensor into the Air Tube (O) by pushing the sensor into the Grommet (L). Seat the sensor into the grommet until the O-ring is not visible.



17. Locate the bolt on the side of the plastic tray that holds the stock intake box and remove it.



SEE EXPLODED VIEW ON PAGE 5



Installation Instructions (continued)

18. Go to Page 4 and choose the setup you prefer.

- Configuration 1: Silicone Hood Seal (C) and Silicone Box Seal (M) Installed
- Configuration 2: Silicone Hood Seal (C) Installed and Silicone Box Seal (M) Not Installed
- Configuration 3: Lid (E) Installed and Silicone Box Seal (M) Not Installed

- **Note:** Configuration 3 is the default setup for this installation instructions.

Warning: Do not install the Polycarbonate Lid with the Silicone Air Box plug. Doing this will cause your filter to collapse and will void your warranty.

19. Drop in the Air Tube (O) and reinstall the harness back into the IAT sensor.



20. Install the Air Box (H) until the tabs snap into the factory grommets. Align the bracket with the hole on the plastic tray. Reuse the bolt from the plastic tray to tighten down the air box. **Note:** If Configuration 1 is chosen, insert the Box Seal (M) before installing the Air Box (H)



21. Install the Hump Coupler (Q) into the throttle body and tighten down the #52 Hose Clamp (P).



22. Install the Crankcase Hose (R) onto the Air Tube (O) and tighten the #12 Hose Clamp (S).



23. Slip the other end of the Crankcase Hose (R) onto the crankcase vent tube. Tighten down the #12 Hose Clamp (S) to secure the hose.



24. Use the two provided Loop Clamp (T) and reuse the retaining bolt to secure the radiator hose.



25. (Optional Step) See Page 4. Remove the protective covering from the Lid (E) and install the Lid Edge Trim (D). Place the lid on top of the Air Box (H) and secure the lid using the four provided Screw (A) and Washer (B). **Note:** Install your Silicone Hood Seal (C) using the provided screws and washers if Configuration 1 or 2 was chosen.



26. Reinstall the plastic engine cover.



27. Reconnect the battery. Inspect your installation, make sure the kit is properly positioned and all fasteners are secure. The installation is now complete.



RELATED ITEMS FOR YOUR PURCHASE

- Replacement Oiled Air Filter (S&B P/N: KF-1057)
- Replacement Dry Air Filter (S&B P/N: KF-1057D)
- Air Filter Wrap (S&B P/N: WF-1058)
- Cleaning & Oiling Kit (S&B P/N: 88-0008)

SEE EXPLODED VIEW ON PAGE 5



Installation Instructions (Choose Your Setup)

Kit Specific Features:

*The 75-5060 kit has three airflow configurations that you can choose from depending on your airflow requirements.

- Configuration 1: Silicone Hood Seal and Silicone Air Box Plug installed
- Configuration 2: Silicone Hood Seal installed and Silicone Air Box Plug not installed
- Configuration 3: Polycarbonate Lid installed and Silicone Air Box plug not installed

The airflow restriction for all three configurations are very similar. Choosing one over another would have minimal effect on performance.

Warning: Do not install the Polycarbonate Lid with the Silicone Air Box plug. Doing this will cause your filter to collapse and will void your warranty.

Configuration 1



Configuration 2



Configuration 3



Performance Testing

- Engage parking brake and start your engine. Listen for abnormal noises. If an air leak is detected, re-inspect hoses and connections as they may need to be repositioned and tightened.
- S&B FILTERS recommends that you keep your OE intake system in the event it is required in the future.
- In order to maintain your warranty, all connections and components must be checked periodically for alignment and for proper tension on all connections. Failure to do so may void your warranty.
- Use only S&B FILTERS cleaning and oil products to service your filter. Using any other brand oil and or cleaners on your S&B air filter may void your warranty.

Warning!

If your vehicle has a Vehicle Emission Control Information decal affixed to the factory airbox, a new replacement label must be obtained and installed in a readily visible position in the engine compartment in order to remain CARB compliant. Failure to do so will prevent the vehicle from passing a smog check. Replacement labels can be ordered from your local dealership. Regulations state that the VEI label shall not be affixed to any equipment which is easily detached from the vehicle. Label placement, under the hood on a painted surface is recommended.



Emissions Standard

The California Air Resource Board (CARB) requires that an E.O. identification label be applied to the vehicle in order to pass a smog check inspection when a Performance Intake Kit has been installed. You must place the E.O. label provided on or near the intake kit after installation so that a smog check technician can easily verify the E.O. number. As of April 2009, S&B has never had a product where CARB denied an exemption request; however, the exemption process with CARB can take as long as 18 months. Check the status of the exemption process by looking up a specific part number at www.sbfilters.com. The CARB Exemption number and/or status is listed under the Product Details section for each part number. If the status shows as "Pending," CARB has yet to issue an exemption. Products that have not been issued an EO number are street legal in most states, but may not be used on emission controlled vehicles in the state of California and are for off road use only. If you purchased your kit from S&B Filters directly, we will automatically mail you your Exemption Sticker when it is issued to us. If you purchased your kit from an authorized S&B Filters Dealer, log onto our web site and register to receive your Exemption Sticker.

SEE EXPLODED VIEW ON PAGE 5



EXPLODED VIEW

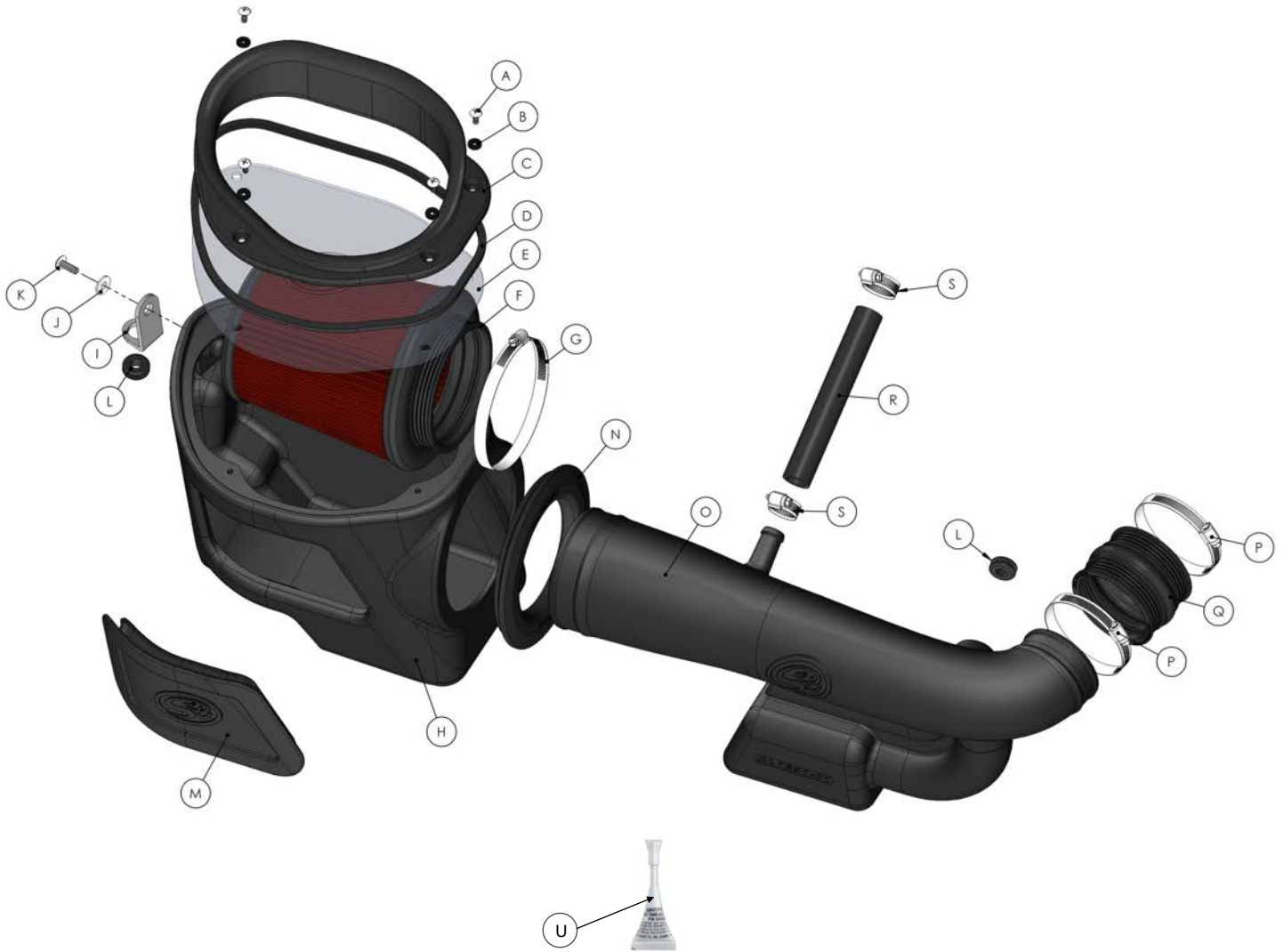

ITEM	QTY.	DESCRIPTION	P/N	ITEM	QTY.	DESCRIPTION	P/N
A	4	#10-24 X 5/8" Truss Head Screw	AI1539-00	O	1	Air Tube	AL1231-01
B	4	#10-24 Rubber Washers	AI1540-00	P	2	Hose Clamp, #52	AG1007-00
C	1	Silicone Hood Seal	AI1681C-00	Q	1	Hump Coupler	AI1601C-00
D	1	Lid Edge Trim	AI1636-06	R	1	Crank Case Hose	AI1040-08
E	1	Lid	AI1680-00	S	2	Hose Clamp, #12	AG1030-00
F	1	Air Filter	KF-1057	U	1	Loctite Thread Locker	AI1595-00
G	1	Hose Clamp, #80	AG-1009-00	ITEMS NOT SHOWN IN THE EXPLODED VIEW			
H	1	Air Box	AL1231B-00	T	2	Loop Clamp	AI1511-00
I	1	Bracket	AI1696-00				
J	1	1/4"-20 Washer	AI1073-00				
K	1	1/4"-20 x .625" Truss Head Screw	AI1569-00				
L	2	Grommets	AI1563-00				
M	1	Silicone Box Seal	AI1682C-00				
N	1	Tube Seal	AI1650C-00				