

**Contents:**

- (1) - Left LED Mirror
- (1) - Right LED Mirror
- (1) - Wiring Kit

**Tools Needed:**

- Drill
- Drill Bits
- Wire Crimper
- Ratchet
- T35 Torx Bit

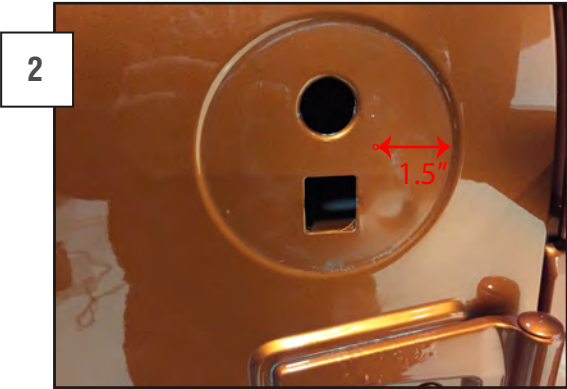

Once the stock mirror is removed, mark 1 1/2" inside the recessed mirror circle. On the Driver side at the 9 o'clock position. On the Passenger side at the 3 o'clock position. Drill a 1/8" pilot hole, finish with a 1/2" hole. \*\*Note: Paint any exposed metal. Then insert the supplied grommet. \*\*Note: 2011+ JK's may not require this step.

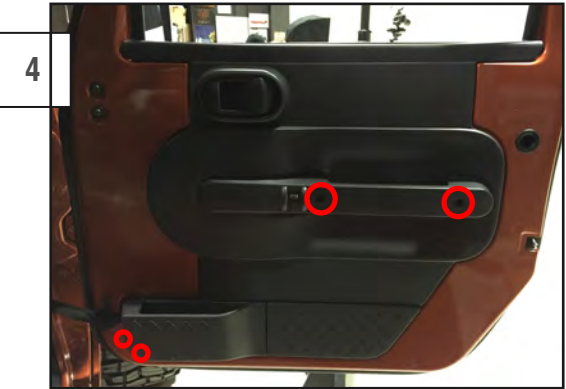

Remove the interior door panels by removing the screws holding the panel to the door. \*\*Note: Factory hardware will be reused. At this point, the door panel will only be held on with the plastic push clips. Firmly pull the door panel from the door. \*\*Note: Depending on year and model the door panels may be secured differently.

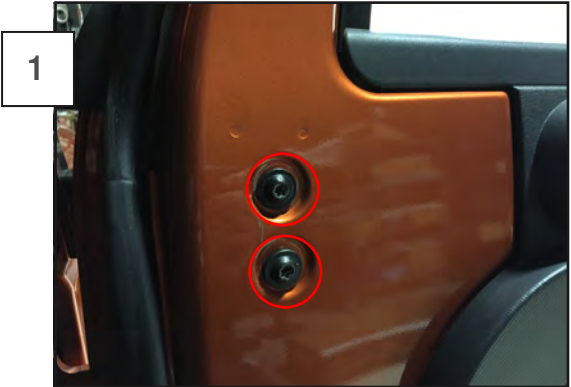

Remove the factory mirror by removing the (2) Torx screws on the inside of the door. \*\*Note: Factory hardware will be reused.

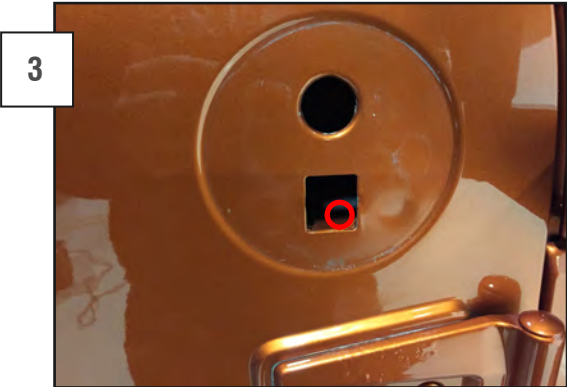

In the lower square hole, you will need to drill a 1/4" hole angled downward through the internal plastic housing. Route the mirror wires through the drilled hole. \*\*Note: 2011+ JK's may not require this step.

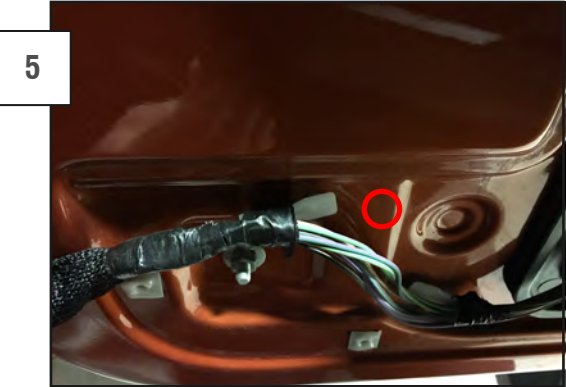

Drill a pilot hole in the location seen above followed by a 1/2" hole. Insert the wire from the mirror through the drilled holes and feed the wires down the door cavity and out the hole drilled in the bottom of the door. Leave enough slack in the wires so that you can remove your mirrors if needed.



Feed the wires through the factory door strap. Ensure there is enough slack in the wires that the door can be completely opened. Reinstall your factory door panel, and tightened the new mirror to the door using the factory (2) Torx screws.

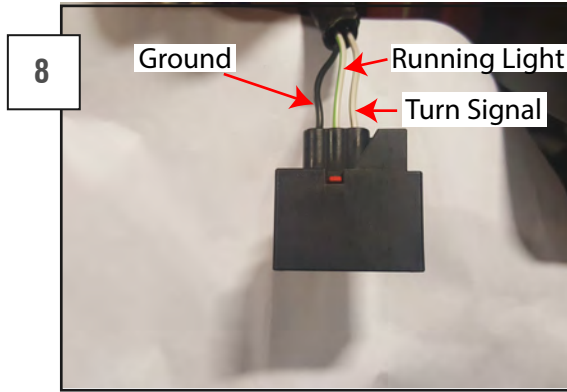

Feed the supplied wiring harness through a factory grommet in the fire wall. Then connect the wiring harness to the vehicle's turn signal harness. Black will be wired to ground, the white wire will be running lights, and the blue wire will be the turn signal light.

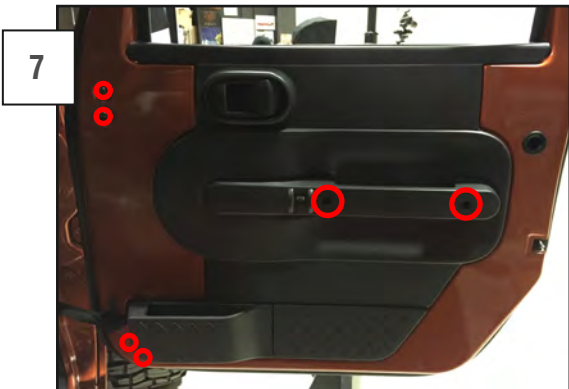

Reinstall your factory door panel, and tighten the new mirror to the door using the factory (2) Torx bolts.



Check all connections, and test when finished.